

NEW

Quick-Point Modular Plates – the powerful set-up time slayer

A new type of plate within the Quick-Point® system now makes zero-point clamping even easier. With the expandable modular plates, which can be flexibly adapted to any machine table, users operate up to five clamping units in succession mechanically with just one tightening screw. This is due to a new patented clamping mechanism within the modular plates, which ensures even higher pull-down forces (approx. 12,000 N) and activates the complete system at the same time. The installation of the modular plates on the machine table offers even greater time-saving potential, as the zero-point plates are connected to each other by precisely fitting connectors, which means that additional alignment is not necessary.

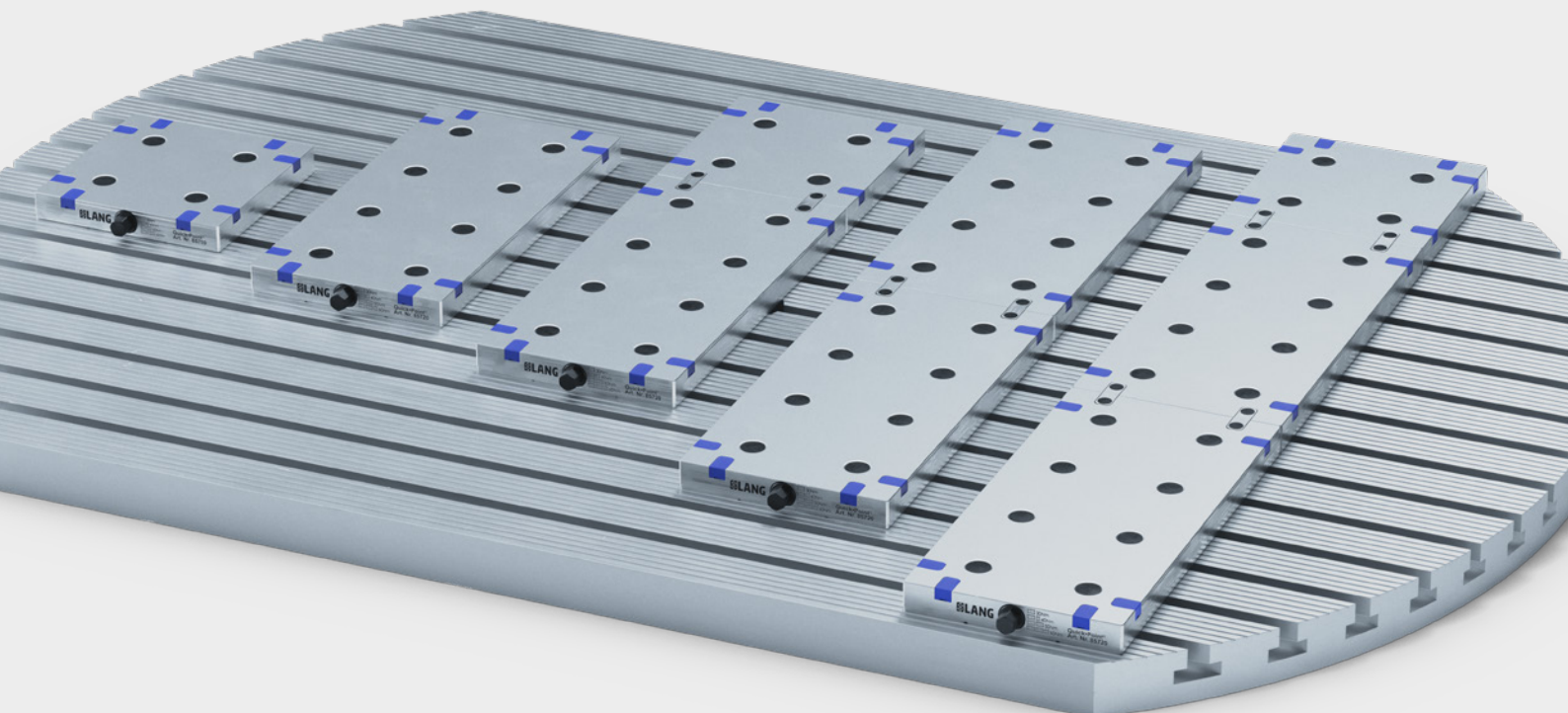
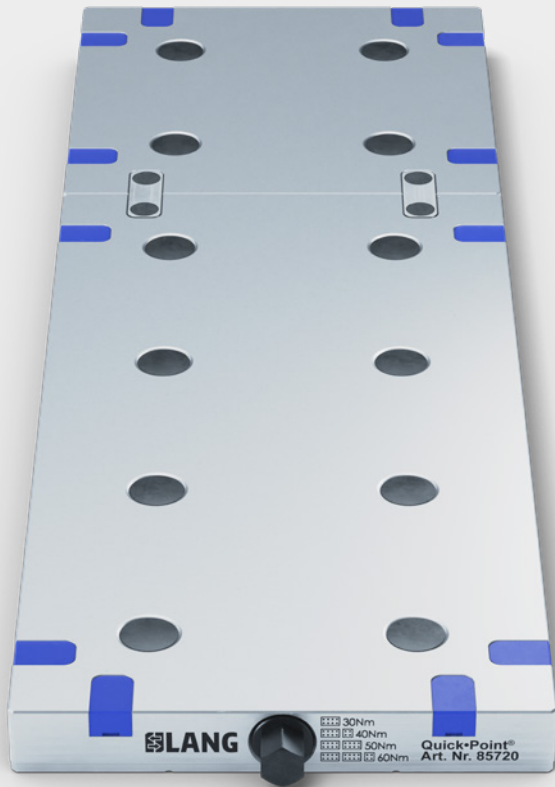

Quick-Point® Modular Plates

NEW

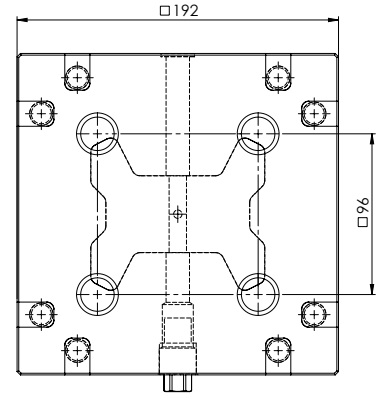

QUICK-POINT® 96, MODULAR PLATE 192 × 192 × 27 MM, WITHOUT MOUNTING BORES

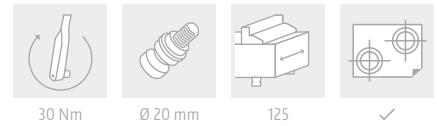

ITEM NO.	DIMENSIONS	WEIGHT
85710	192 × 192 × 27 mm	7.4 kg
45004	Set mounting bores according to customer's request	
45002	Set keyways according to customer's request	

NEW

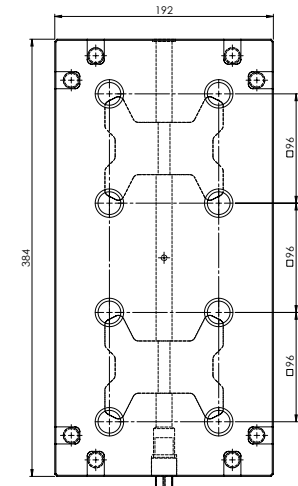

QUICK-POINT® 96, 2-FOLD MODULAR PLATE 384 × 192 × 27 MM, WITHOUT MOUNTING BORES

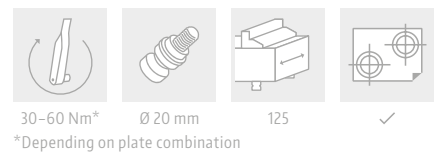

ITEM NO.	DIMENSIONS	WEIGHT
85720	384 × 192 × 27 mm	14.8 kg
45024	Set mounting bores according to customer's request	
45022	Set keyways according to customer's request	

NEW



QUICK-POINT® CONVERSION KIT FOR MODULAR PLATES

ITEM NO.	UNIT	WEIGHT
85700	1 pressure bolt, 2 connectors	0.3 kg

The conversion set, which includes a pressure bolt and two connectors, is required when modular plates are to be connected in series, in order to operate the entire clamping mechanism via the tightening screw of the front modular plate. Due to the precise fit of the connectors the alignment of modular plates towards each other is no longer necessary.

NEW



QUICK-POINT® CONNECTION SET FOR MODULAR PLATES

ITEM NO.	QUANTITY	WEIGHT
85701	2 pieces	0.1 kg

The connection set for the Quick-Point® modular plates is not only part of the the conversion kit (item no. 85700), but available individually, in order to connect neighboring modular plates with each other and to enable a zero-point grid across the plates in x-direction.

NEW

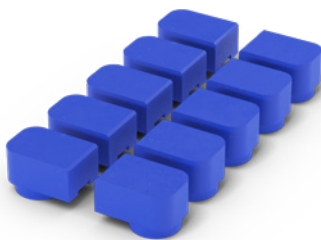

QUICK-POINT® COVERS FOR MODULAR PLATES

ITEM NO.	QUANTITY	WEIGHT
85702	10 pieces	0.05 kg

The plastic covers close those recesses of the Quick-Point® modular plates to which no further modular plate is added. They are available in sets of 10. Both modular plates (item no. 85710 and 85720) are supplied with 8 covers each.